

Intermec 条码打印机免费服务热线：400-1199-021
syCoder F4

P/N
1-960468-0
3
Edition 4
February
2001



Brugervejledning
Gebrauchsanleitung
Οδηγίες χρήσης

User's Guide
Guia de usuario
Guide d'utilisation

The Intermec logo consists of a red stylized 'I' followed by the word 'ntermec' in a bold, lowercase, sans-serif font.

TechnisCrutin
a Google, Inc. product

A **UNOVA** Company

.....
..... 5

.....
..... 9

.....
..... 13

.....
..... 15

.....
..... 19

.....
..... 23

.....
..... 24

.....
..... 28

.....
..... 27

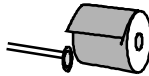
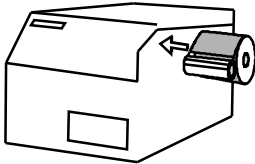
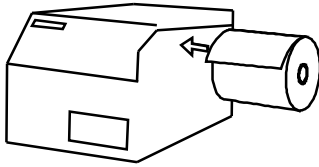

FCC Notice (United States of America)

WARNING

This equipment generates, uses, and can radiate radio frequency energy and if not installed and used in accordance with the instructions manual, may cause interference to radio communications. It has been tested and found to comply with the limits for a Class A computing device pursuant to Subpart J of Part 15 of FCC Rules, which are designed to provide reasonable protection against such interference when operated in a commercial environment. Operation of this equipment in a residential area is likely to cause interference in which case the user at his own expense will be required to take whatever measures may be required to correct the interference.

DOC Notice (Canada)

Canadian Dept. of Communication REGULATIONS COMPLIANCE (DOC-A)

This digital apparatus does not exceed the class A limits for radio noise emissions from a digital apparatus as set out in the radio interference regulations of the Canadian Department of Communication.

Ministère des Communications du Canada CONFORMITE DE REGLEMENTS (DOC-A)

Le présent appareil numérique n' émet pas de bruits radio-électriques dépassant les limites applicables aux appareils numériques de classe A prescrites dans le règlement sur brouillage radioélectrique édicté par le Ministère des Communications du Canada.

GS Notice (Germany)

ALLGEMEINE VORSCHRIFT

Reparaturen oder sonstige Eingriffe, die sich nicht auf normale Bedienung der Maschine beziehen, dürfen ausschließlich nur von einem ausgebildeten, zuständigen Fachmann vorgenommen

werden.

EU Standard EN 55022 (The European Union)

WARNING

This is a Class A ITE product. In a domestic environment this product may cause radio interference in which case the user may be required to take adequate measures.

Declaration of Conformity

We,
Intermec Printer AB
Idrottsvägen 10
Box 123
S-431 22 Mölndal
Sweden

declare under our sole responsibility, that the product

EasyCoder F4

to which this declaration relates
is in conformity with the following standards

EEMC:

EN 50 081-1:1992

EN 55 022:1994

EN 61 000-3-2:1995, class A

EN 50 082-2:1995

EN 61 000-4-2:1995

EN 61 000-4-3:1996

ENV 50 204:1995

EN 61 000-4-4:1995

EN 61 000-4-6:1996

Electrical Safety:

EN 60 950

following the provisions of Directives

89/336/EEC and 73/23/EEC

Mölndal 1999-10-18

.....
.....
Mats Gunnarsson
President

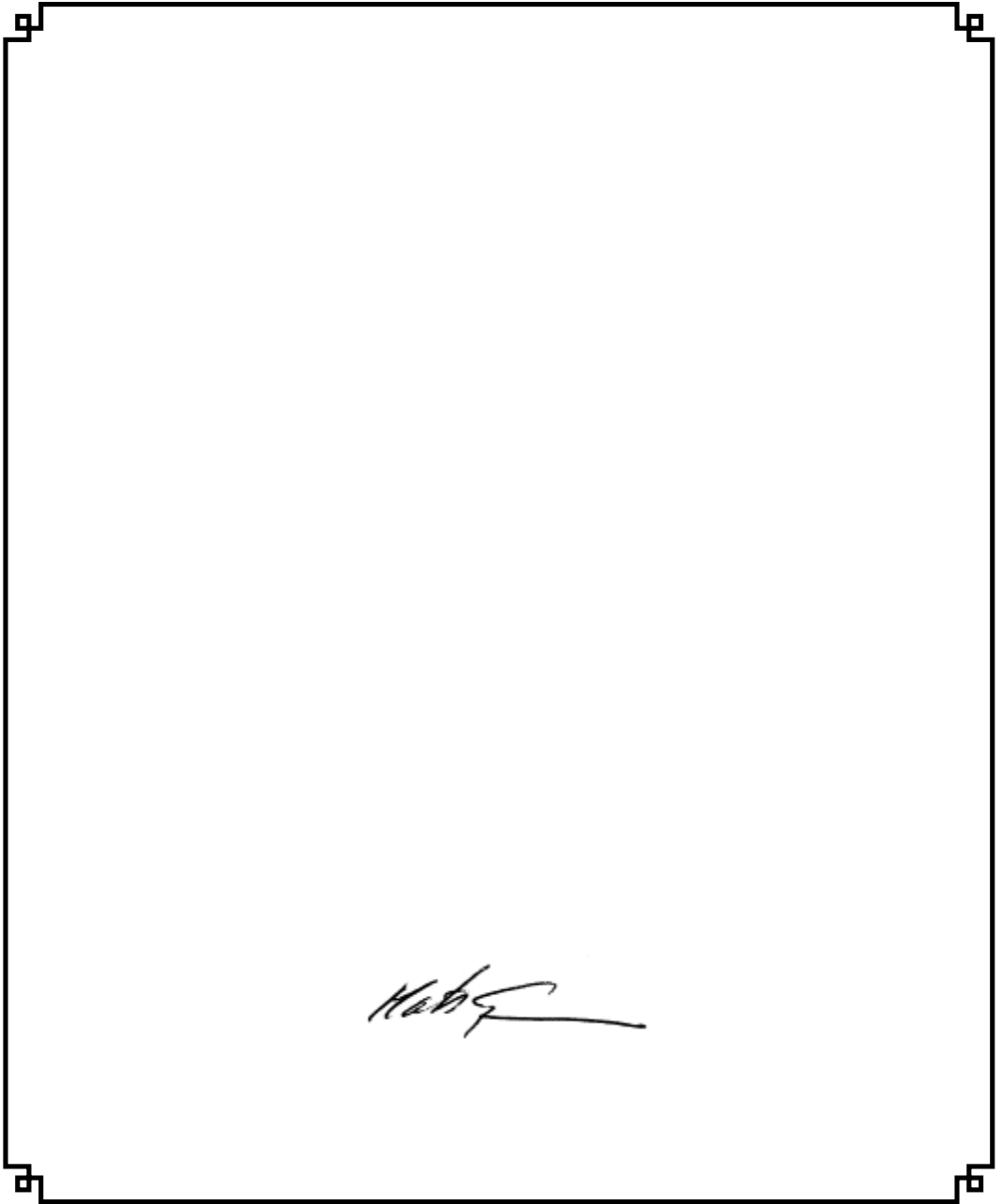

Handwritten signature

EasyCoder F4

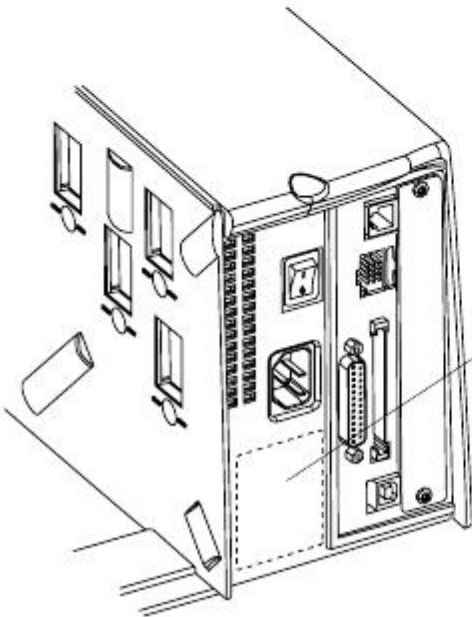
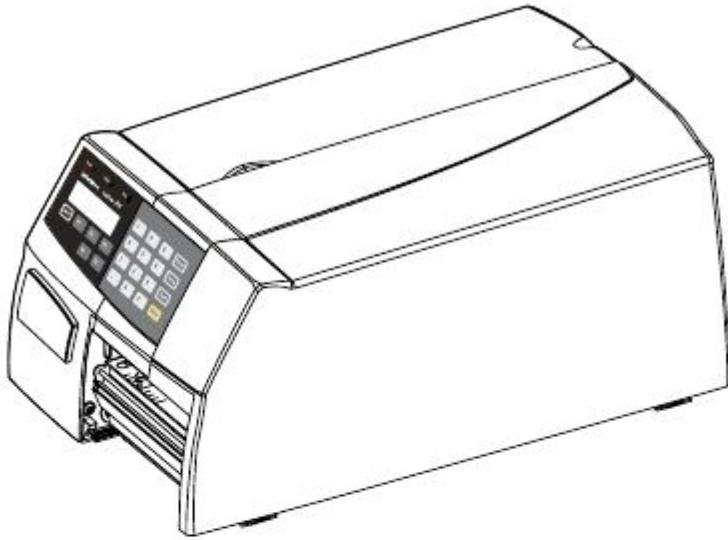

EasyCoder F4	
Configuration # GF4XXXXXXXX	
Serial # 00021	
100-240V 2-1A 50/60Hz	
INTERMEC PRINTER AB • MADE IN SWEDEN	

Dansk Sikkerhedsforskrifter
Deutsch Sicherheitsvorschriften

English Safety requirements
Español Instrucciones de seguridad
Français Consignes de sécurité

Dansk

Intermec frasiger sig ethvert ansvar for opfyldelse af CE-direktivet, såfremt printeren anvendes, ændres eller installeres på anden måde end anført i Intermecs manualer.

Deutsch

Intermec lehnt jede Verantwortung für die Erfüllung der CE-Direktive ab, falls der Drucker nicht auf die im Intermec-Manual beschriebene Weise bedient, modifiziert oder installiert wird.

Ε λ λ η ν ι κ α

Η Intermec Printer AB α πο πο ι ε ι τ α ι κ α θ ε ε υ θ υ ν η σ χ ε τ ι κ η
α ε τ η ν τ η ρ η σ η τ ω υ δ ι α τ α ξ ε ω ν

Χ Ε σ τ η ν π ε ρ ι π τ ω σ η π ο υ χ ε ι ρ ι σ α ο ς, η α ε τ α τ ρ ο π η η η ε
γ κ α τ α σ τ α σ η τ ο υ ε κ τ υ π ω τ η γ ι ν ε ι

κ α τ α τ ρ ο π ο α λ λ ο α π ο α υ τ ο ν π ο υ π ε ρ ι γ ρ α φ ε τ α ι σ τ α
ε γ χ ε ι ρ ι δ ι α χ ρ η σ η ς τ η ς Intermec

Printer AB.

English

Intermec assumes no responsibility regarding the CE Directive if the printer is handled, modified or

installed in other manners than those described in Intermec's manuals.

Español

Intermec renuncia a toda responsabilidad de cumplir con el directivo CE si la impresora está utilizada,

montada o instalada de algún otro modo que los descritos en los manuales de Intermec.

Français

Intermec décline toute responsabilité quant au respect des prescriptions CE si l'imprimante est utilisée,

modifiée ou installée contrairement aux procédures décrites dans les manuels Intermec.



Ελληνικά

Κανονισμοι ασφαλειας

<i>Italiano</i>	Disposizioni di sicurezza
<i>Nederlands</i>	Veiligheidsvoorschriften
<i>Norsk</i>	Sikkerhetsforskrifter
<i>Português</i>	Normas de segurança
<i>Suomeksi</i>	Turvamääräykset
<i>Svenska</i>	Säkerhetsföreskrifter

Italiano

Intermec declina ogni responsabilità relativa all'osservanza della direttiva CE se la stampante viene utilizzata, modificata o installata in modo diverso da quanto descritto nei manuali Intermec.

Nederlands

Intermec aanvaardt geen enkele aansprakelijkheid om te voldoen aan de CE-richtlijnen als de printer op een andere wijze wordt behandeld, gemodificeerd of geïnstalleerd, dan wordt beschreven in de handleidingen van Intermec.

Norsk

Intermec fraskriver seg alt ansvar for å oppfylle CE-direktivet hvis printeren håndteres, modifieres eller installeres på annen måte enn som beskrevet i Intermec's brukerveiledninger.

Português

A Intermec declina toda a responsabilidade, que para ela decorre do cumprimento da Directiva CE, se a impressora for utilizada, modificada, ou instalada de modo que contrarie as indicações dos manuais Intermec.

Suomeksi

Intermec irtisanoutuu kaikesta vastuusta täyttää CE Ohje jos kirjoitinta käsitellään, sitä muutetaan tai se asennetaan muulla kuin Intermecin käsikirjoissa kuvatulla tavalla.

Svenska

Intermec frånsäger sig allt ansvar att uppfylla CE Direktivet om printern hanteras, modifieras, monteras eller installeras på andra sätt än de som beskrivs i Intermecs manualer.





Isopropyl Alcohol

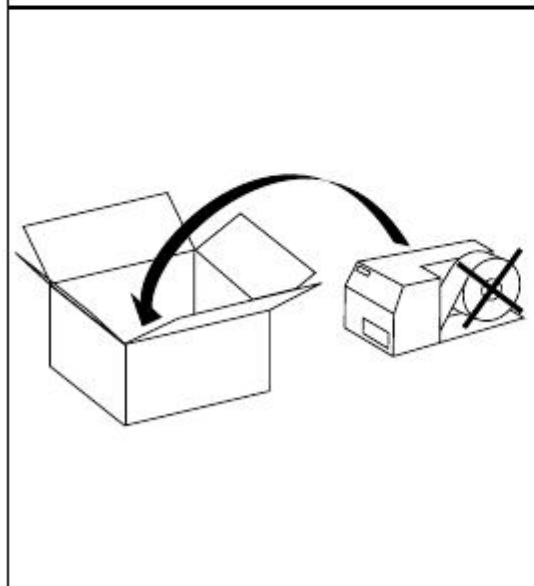
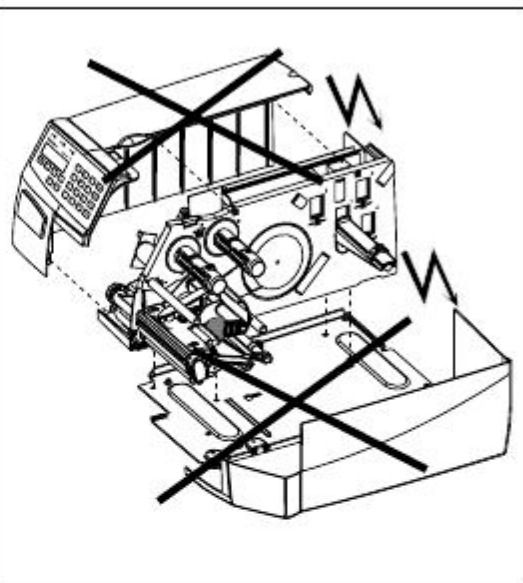
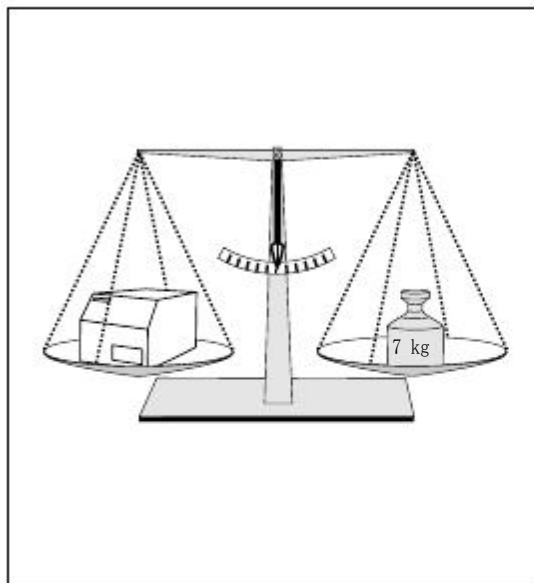

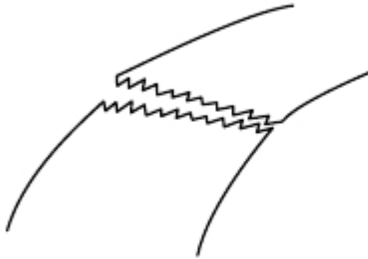

<i>Dansk</i>	Isætning af papir - Afriv
<i>Deutsch</i>	Nachfüllen von Papier - Abreißen
<i>Ελληνικά</i>	Τοποθέτηση χαρτίου - Σκιοσιμο ετικετας
<i>English</i>	Paper load - Tear off
<i>Español</i>	Carga de papel - Arrancar
<i>Français</i>	Chargement du papier - Déchirer
<i>Italiano</i>	Caricamento della carta - Strappare
<i>Nederlands</i>	Het laden van papier - Afscheuren
<i>Norsk</i>	Lading av papir - Riv av
<i>Português</i>	Colocação do papel - Rasgue
<i>Suomeksi</i>	Paperin lataaminen - Repäise
<i>Svenska</i>	Laddning av papper - Riv av

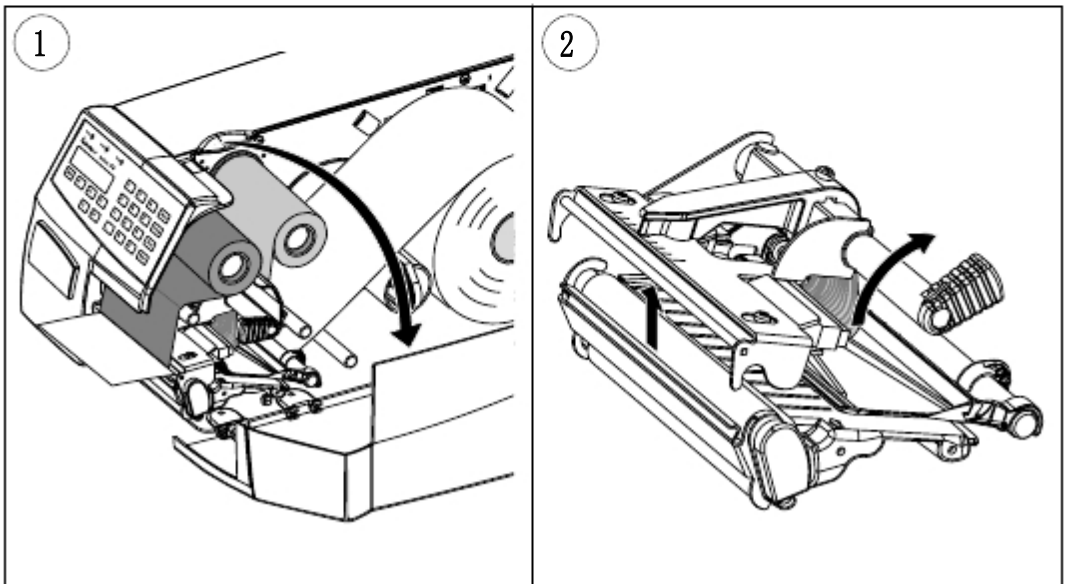

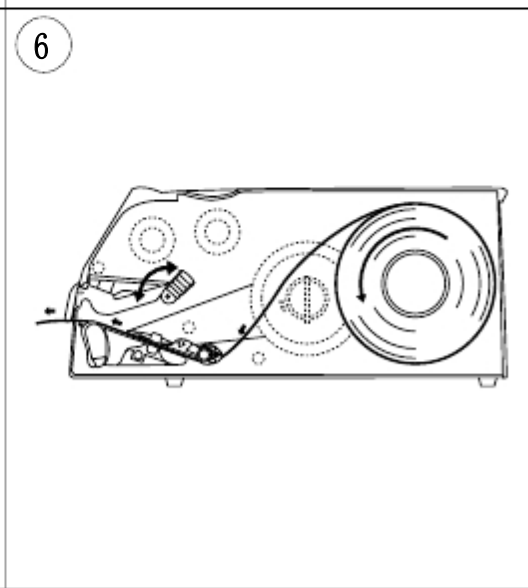
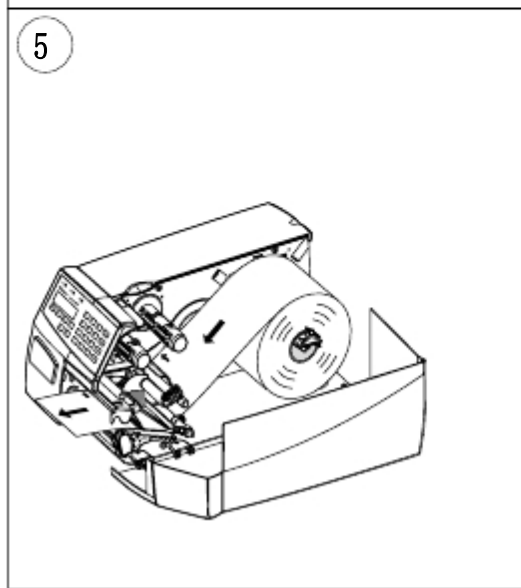
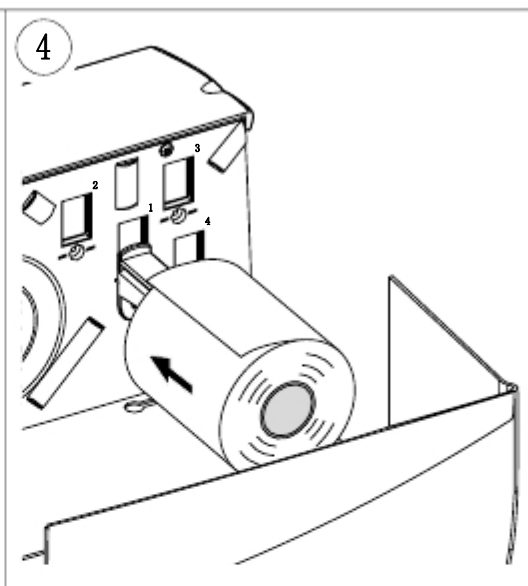
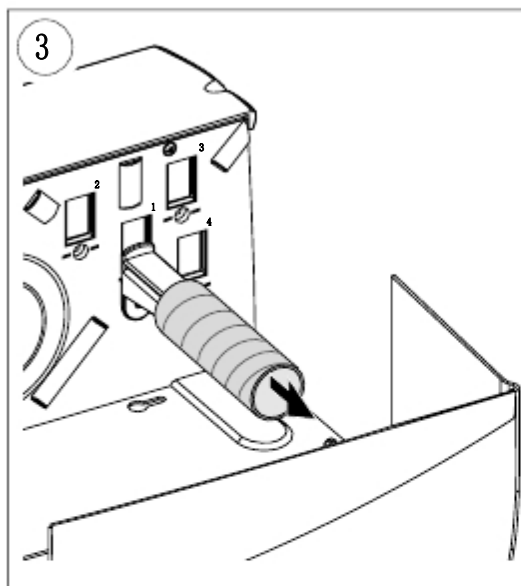

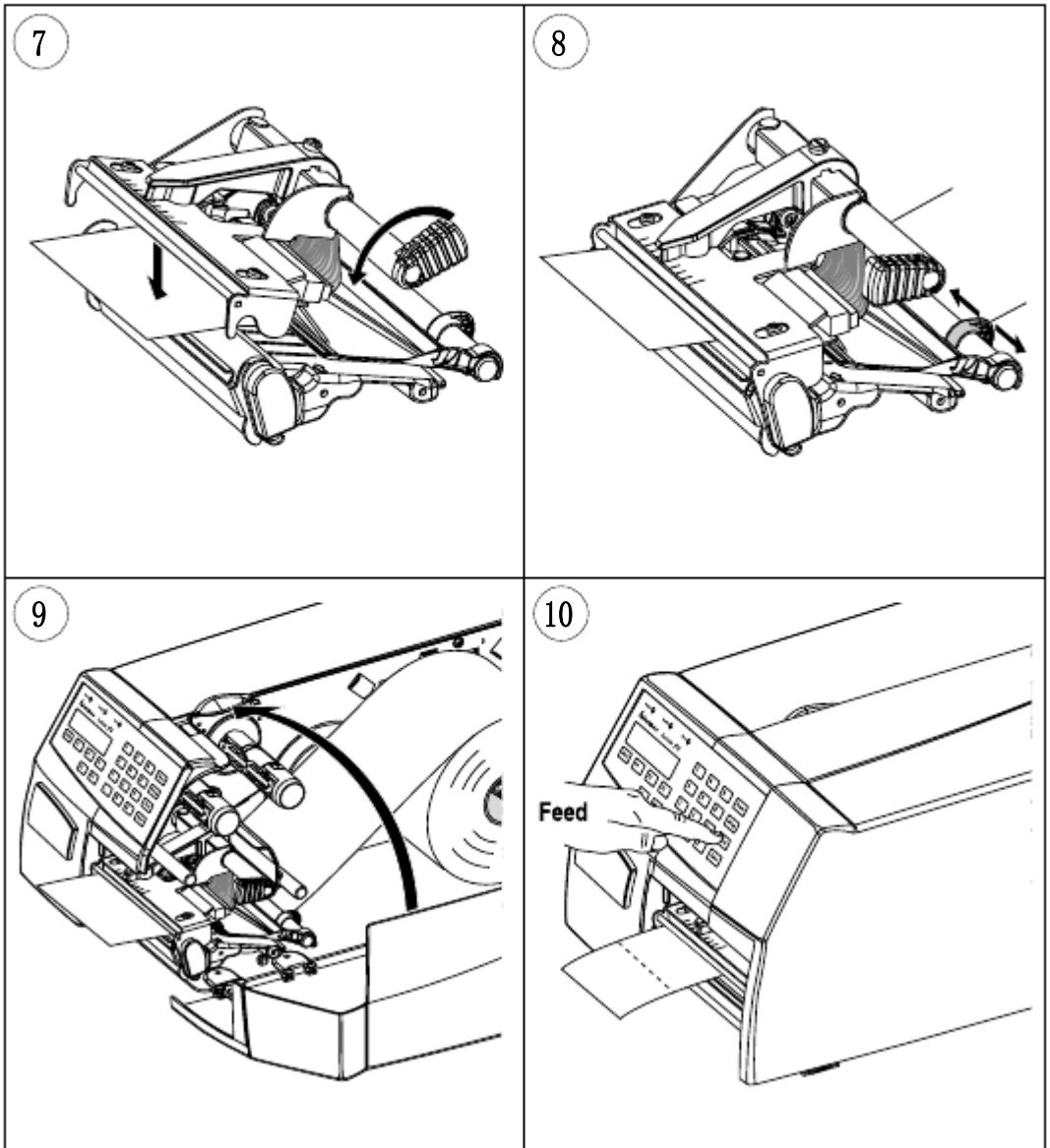

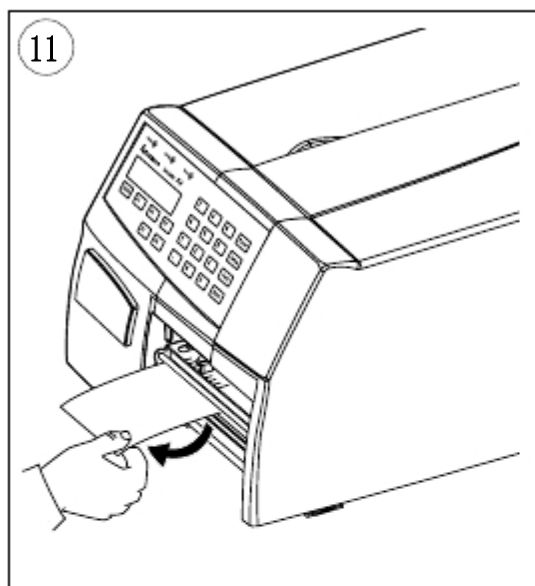

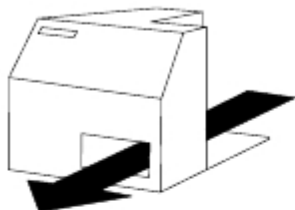

<i>Dansk</i>	Isætning af papir - Quick-Load
<i>Deutsch</i>	Nachfüllen von Papier - Quick-Load
<i>Ελληνικά</i>	Τοποθέτηση χαρτίου - Quick-Load
<i>English</i>	Paper load - Quick-Load
<i>Español</i>	Carga de papel - Quick-Load
<i>Français</i>	Chargement du papier - Quick-Load
<i>Italiano</i>	Caricamento della carta - Quick-Load
<i>Nederlands</i>	Het laden van papier - Quick-Load
<i>Norsk</i>	Lading av papir - Quick-Load
<i>Português</i>	Colocação do papel - Quick-Load
<i>Suomeksi</i>	Paperin lataaminen - Quick-Load
<i>Svenska</i>	Laddning av papper - Quick-Load

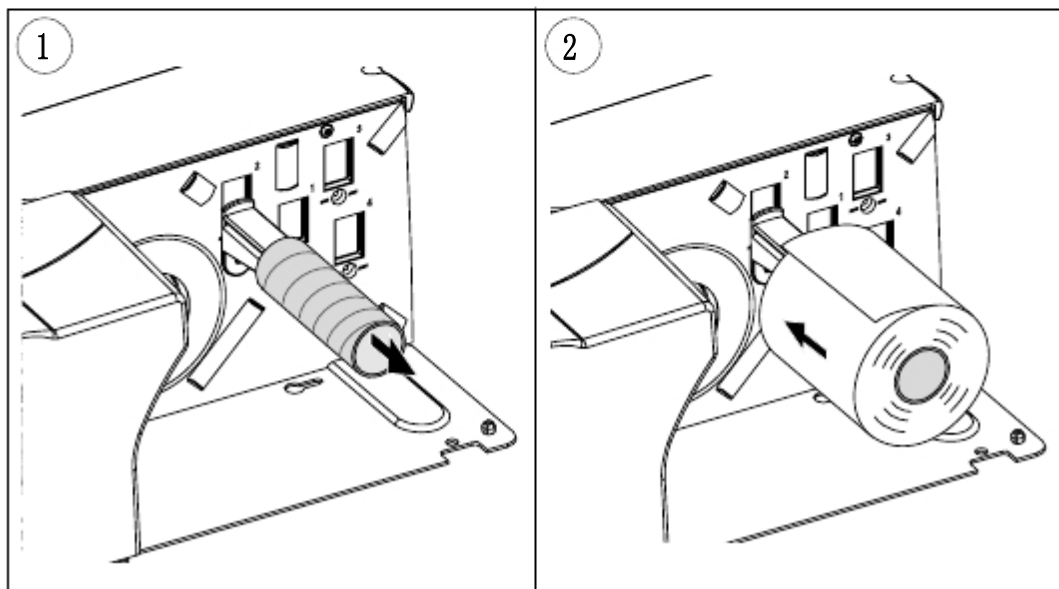

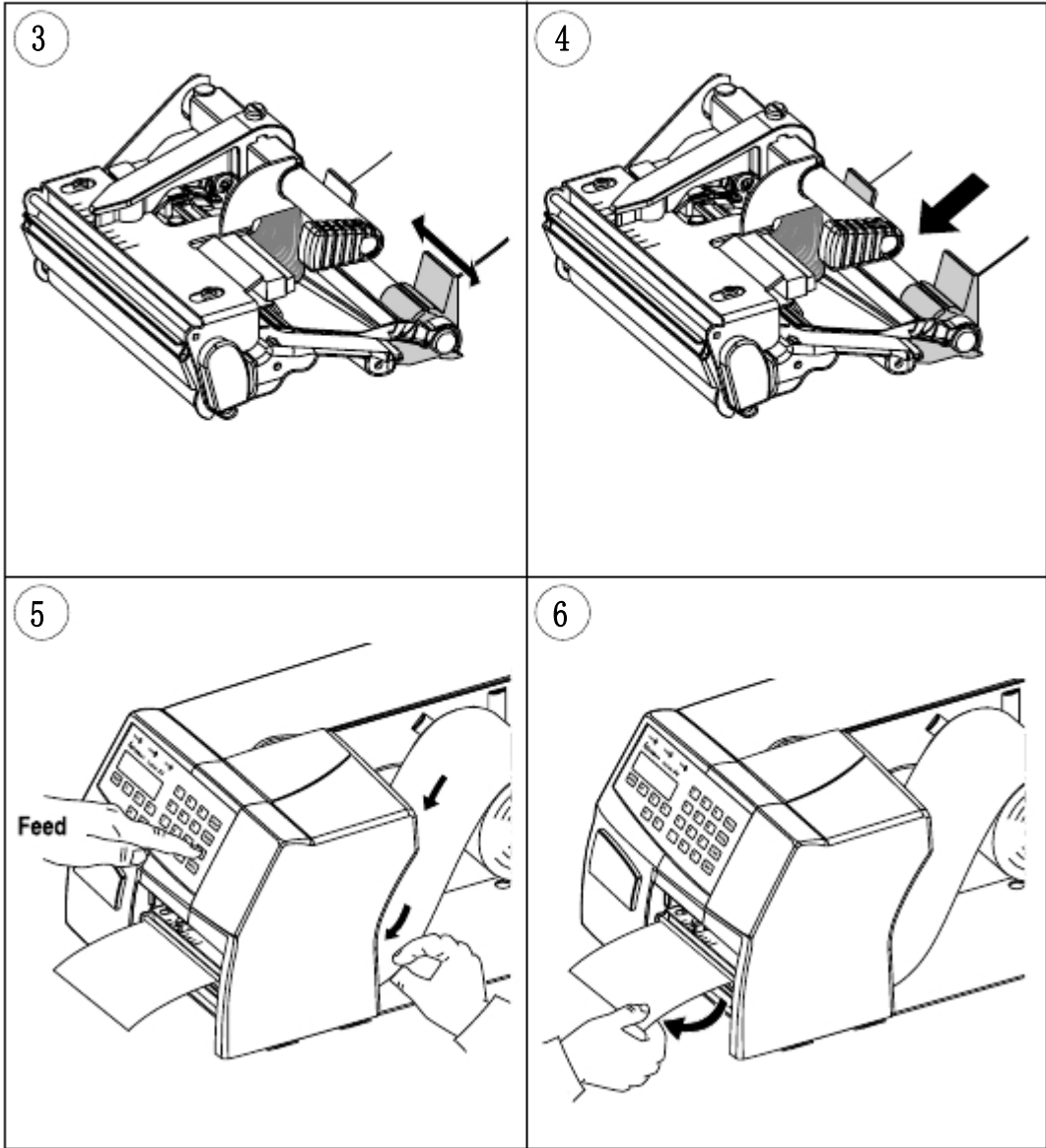

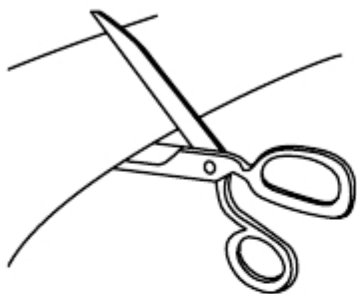

<i>Dansk</i>	Isætning af papir - Klip af
<i>Deutsch</i>	Nachfüllen von Papier - Abschneiden
<i>Ελληνικά</i>	Τοποθέτηση χαρτίου - Κοπή ετικετας
<i>English</i>	Paper load - Cut off
<i>Español</i>	Carga de papel - Cortar
<i>Français</i>	Chargement du papier - Découper
<i>Italiano</i>	Caricamento della carta - Tagliare
<i>Nederlands</i>	Het laden van papier - Afknippen
<i>Norsk</i>	Lading av papir - Klipp av
<i>Português</i>	Colocação do papel - Corte
<i>Suomeksi</i>	Paperin lataaminen - Leikkaa
<i>Svenska</i>	Laddning av papper - Klipp av

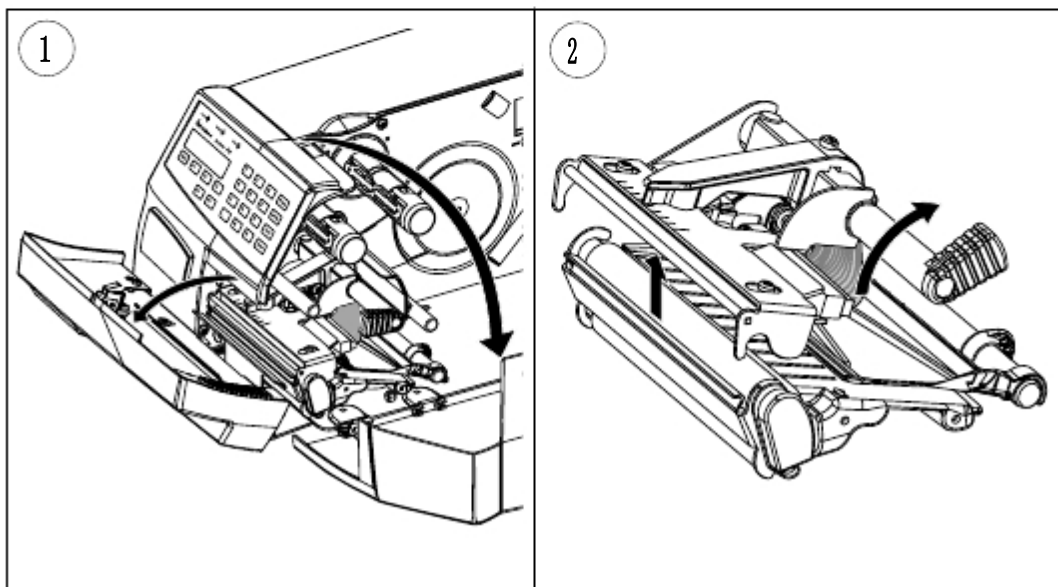

3

4

2 3
4 1

4 2 3

5 6

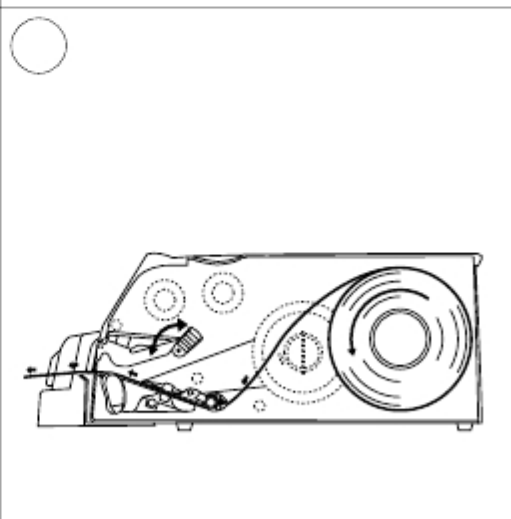
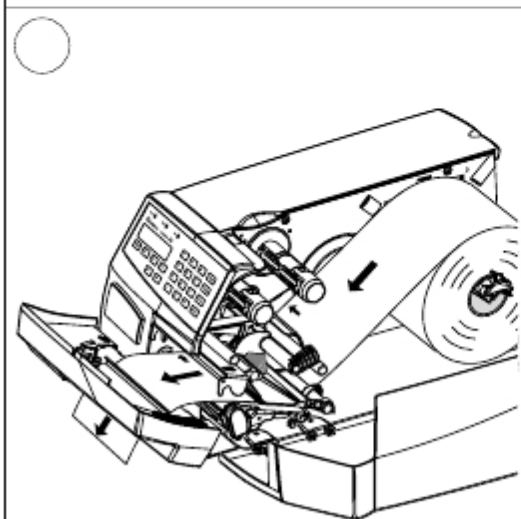
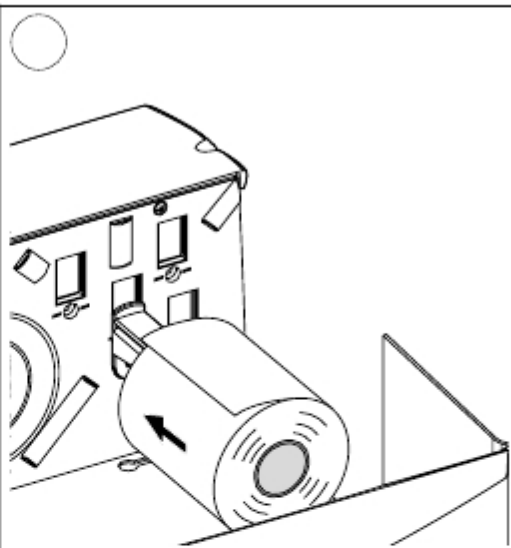
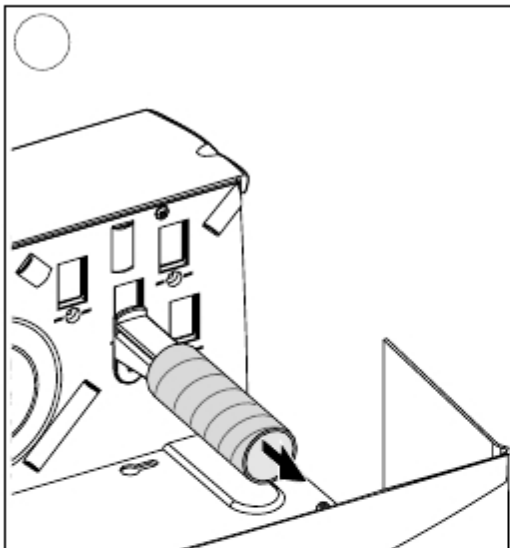

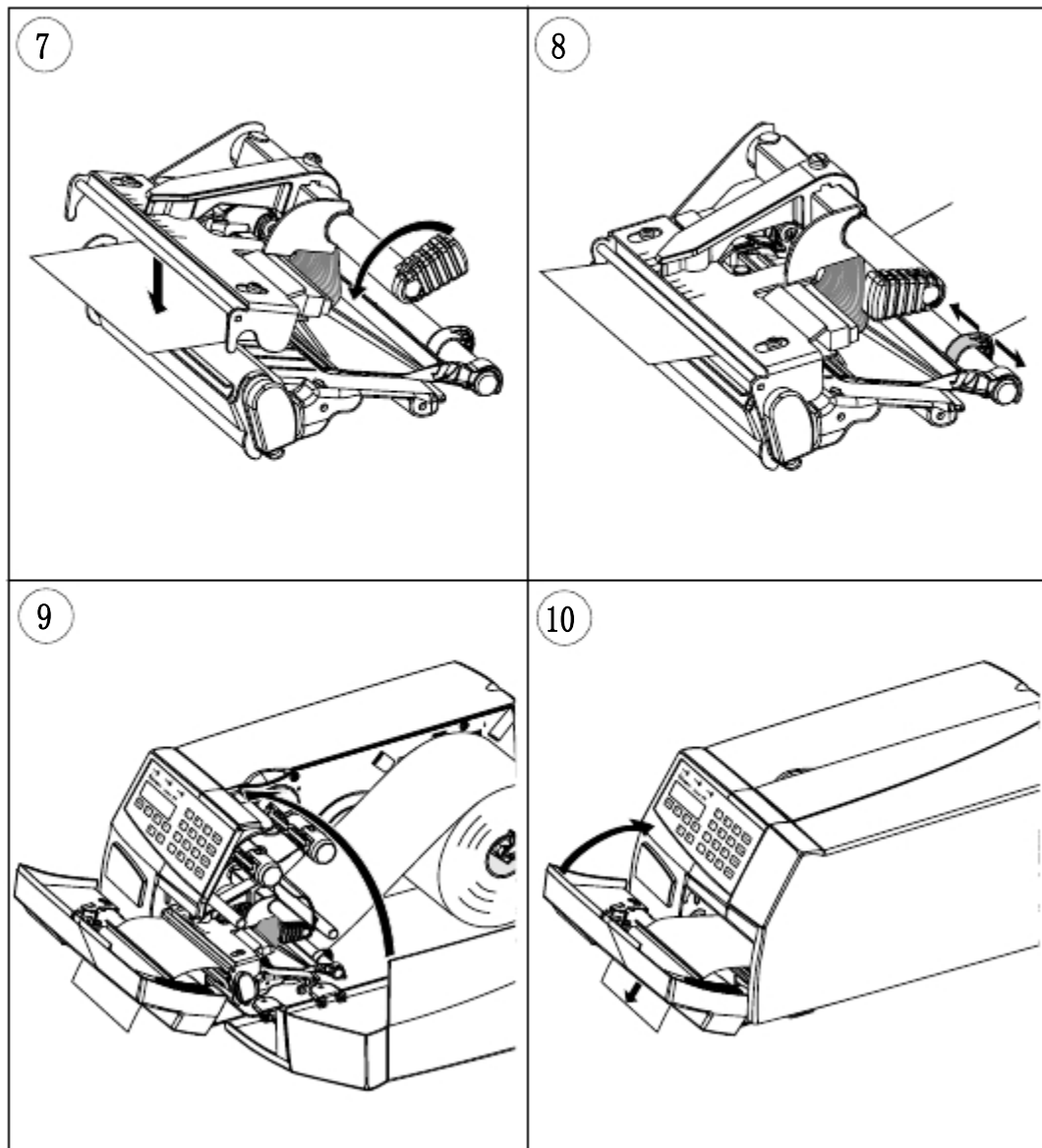

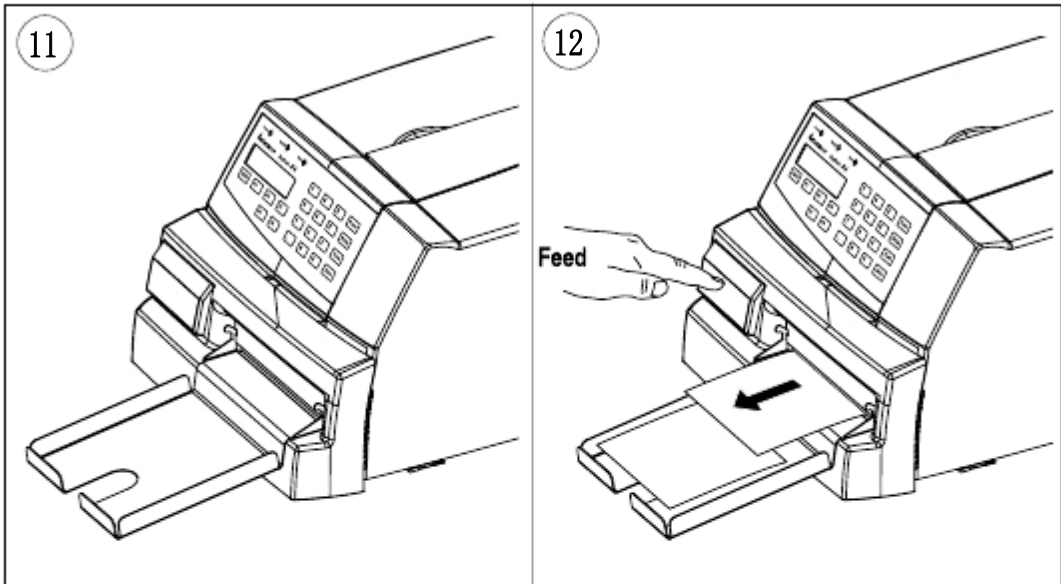

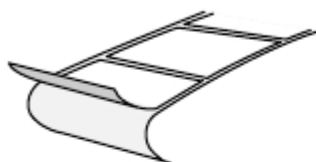

<i>Dansk</i>	Isætning af papir - Dispensering
<i>Deutsch</i>	Nachfüllen von Papier - Spendebetrieb
<i>Ελληνικά</i>	Τοποθέτηση χαρτίου - Αποκόλληση ετικετας
<i>English</i>	Paper load - Peel off
<i>Español</i>	Carga de papel - Dispensador
<i>Français</i>	Chargement du papier - Décollage automatique
<i>Italiano</i>	Caricamento della carta - Distribuzione
<i>Nederlands</i>	Het laden van papier - Vrijmaken
<i>Norsk</i>	Lading av papir - Dispensering
<i>Português</i>	Colocação do papel - Descolagem
<i>Suomeksi</i>	Paperin lataaminen - Dispensointi
<i>Svenska</i>	Laddning av papper - Dispensering

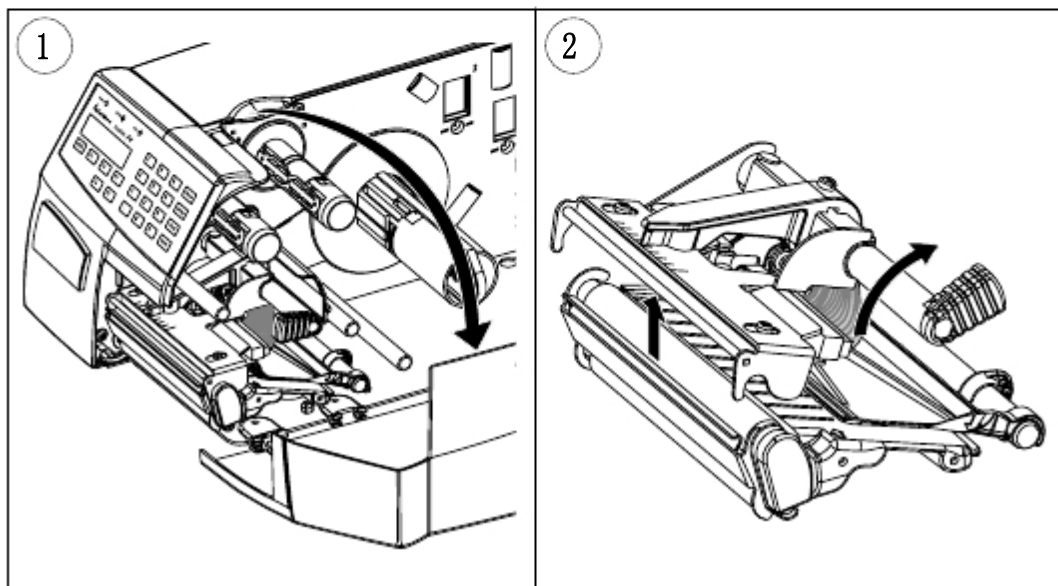

3

4

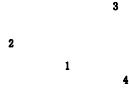

5

6

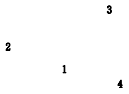

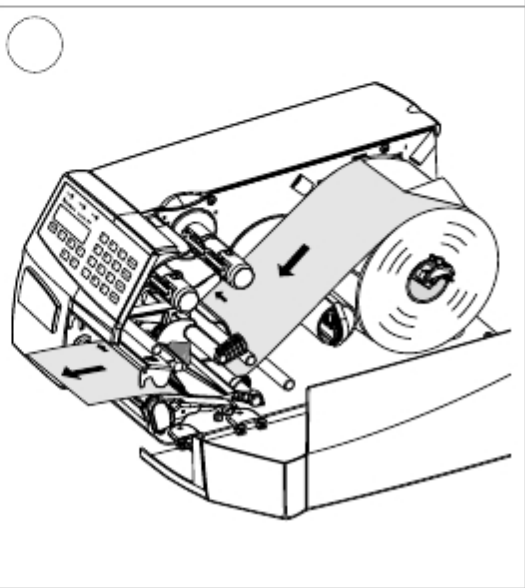
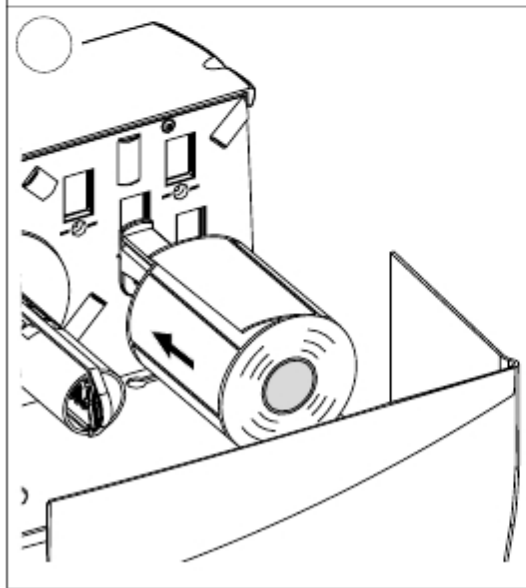
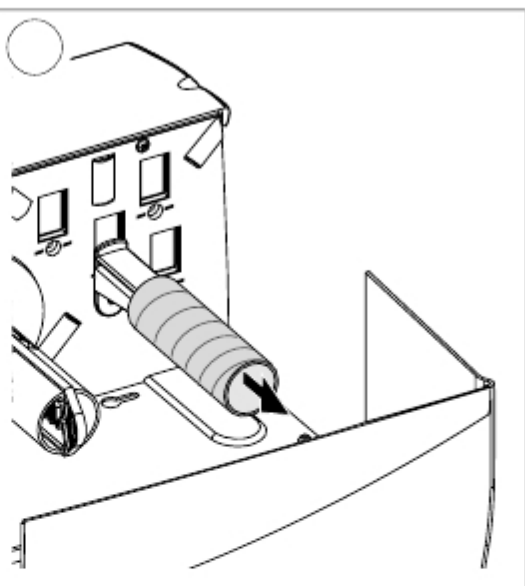
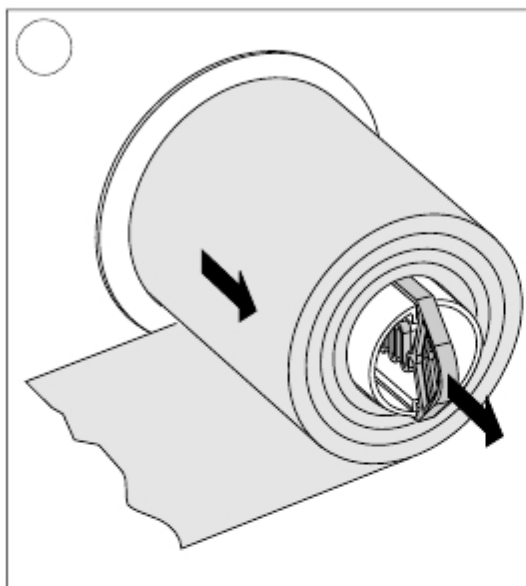

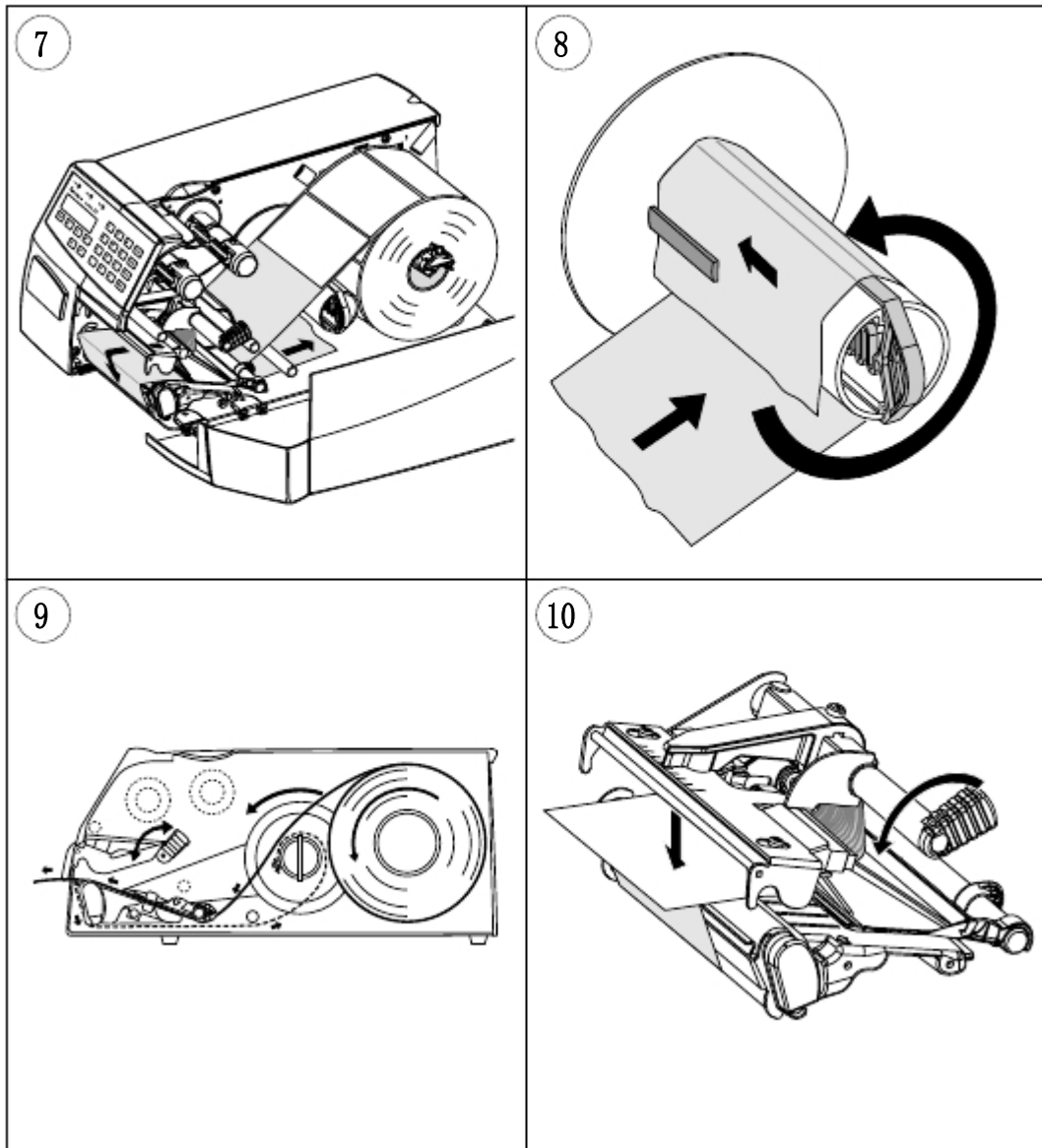

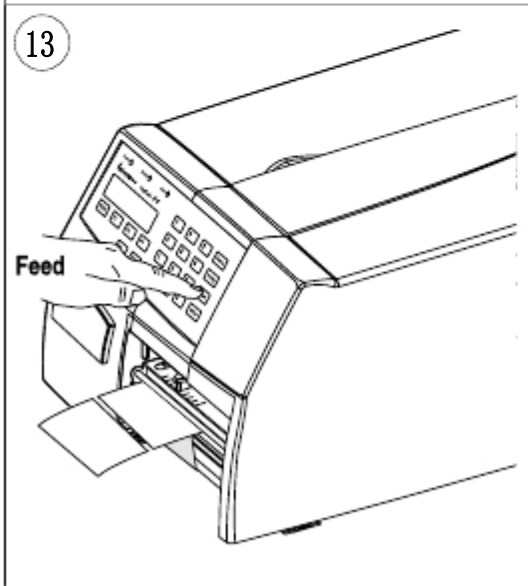
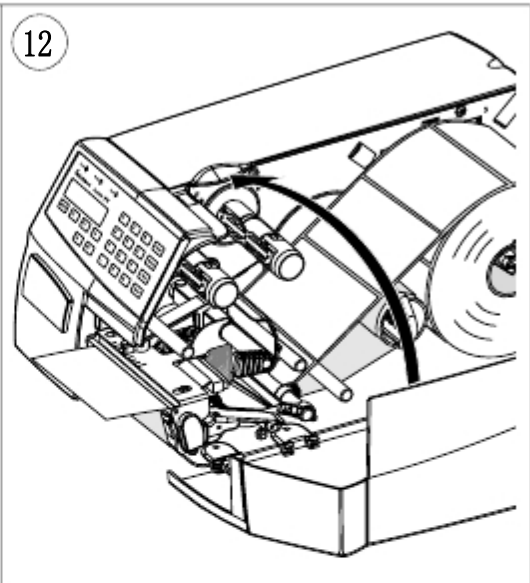
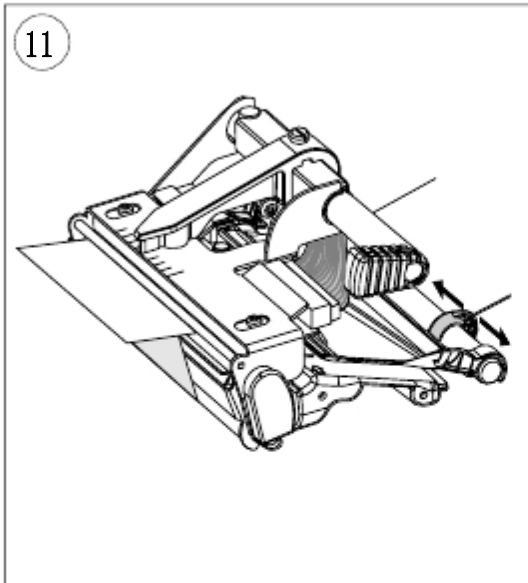

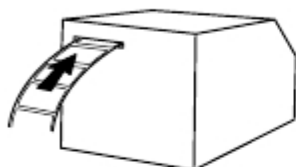

<i>Dansk</i>	Isætning af papir - Udvendigt magasin
<i>Deutsch</i>	Nachfüllen von Papier - Außenmagazin
<i>Ελληνικά</i>	Τοποθέτηση χαρτίου - Παροχή απο εξωτερικο ρολο
<i>English</i>	Paper load - External supply
<i>Español</i>	Carga de papel - Alimentación externa
<i>Français</i>	Chargement du papier - Alimentation externe
<i>Italiano</i>	Caricamento della carta - Magazzino esterno
<i>Nederlands</i>	Het laden van papier - Uitwendig magazijn
<i>Norsk</i>	Lading av papir - Utvendig magasin
<i>Português</i>	Colocação do papel - Caixa externa
<i>Suomeksi</i>	Paperin lataaminen - Ulkokuolinen makasiini
<i>Svenska</i>	Laddning av papper - Utvändigt magasin

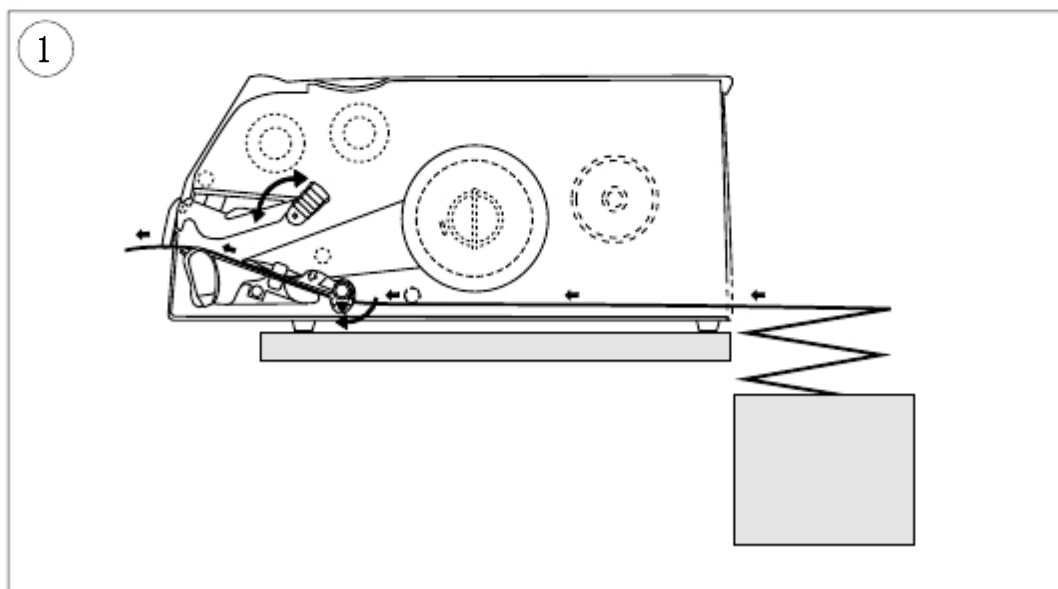

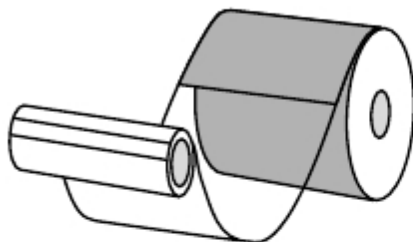
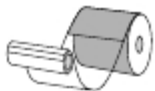

Dansk

Deutsch

Ελληνικά

English

Español

Français

Italiano

Nederlands

Norsk

Português

Suomeksi

Svenska

Isætning af farvebånd

Nachfüllen des Farbbandes

Γοποθέτηση μελανοταινιας

Ribbon load

Carga de cinta

Mise en place du ruban encreur

Caricamento del nastro

Het laden van de kleurband

Lading av farvebånd

Colocação do rolo de filme

Värinahan lataaminen

Laddning av färgband

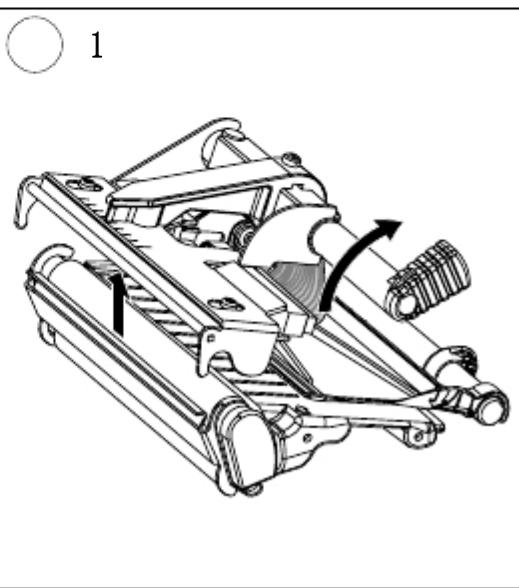
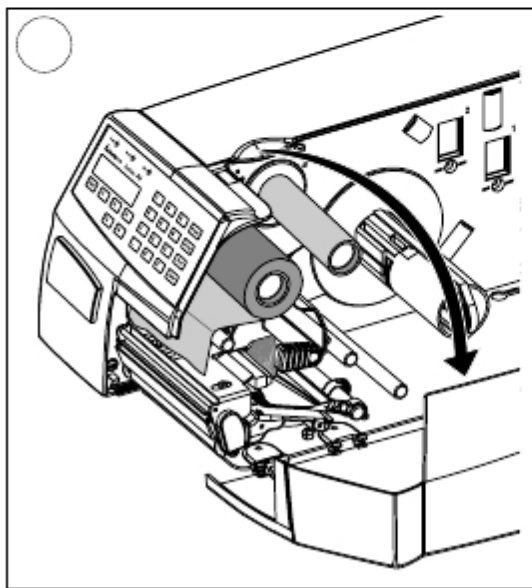

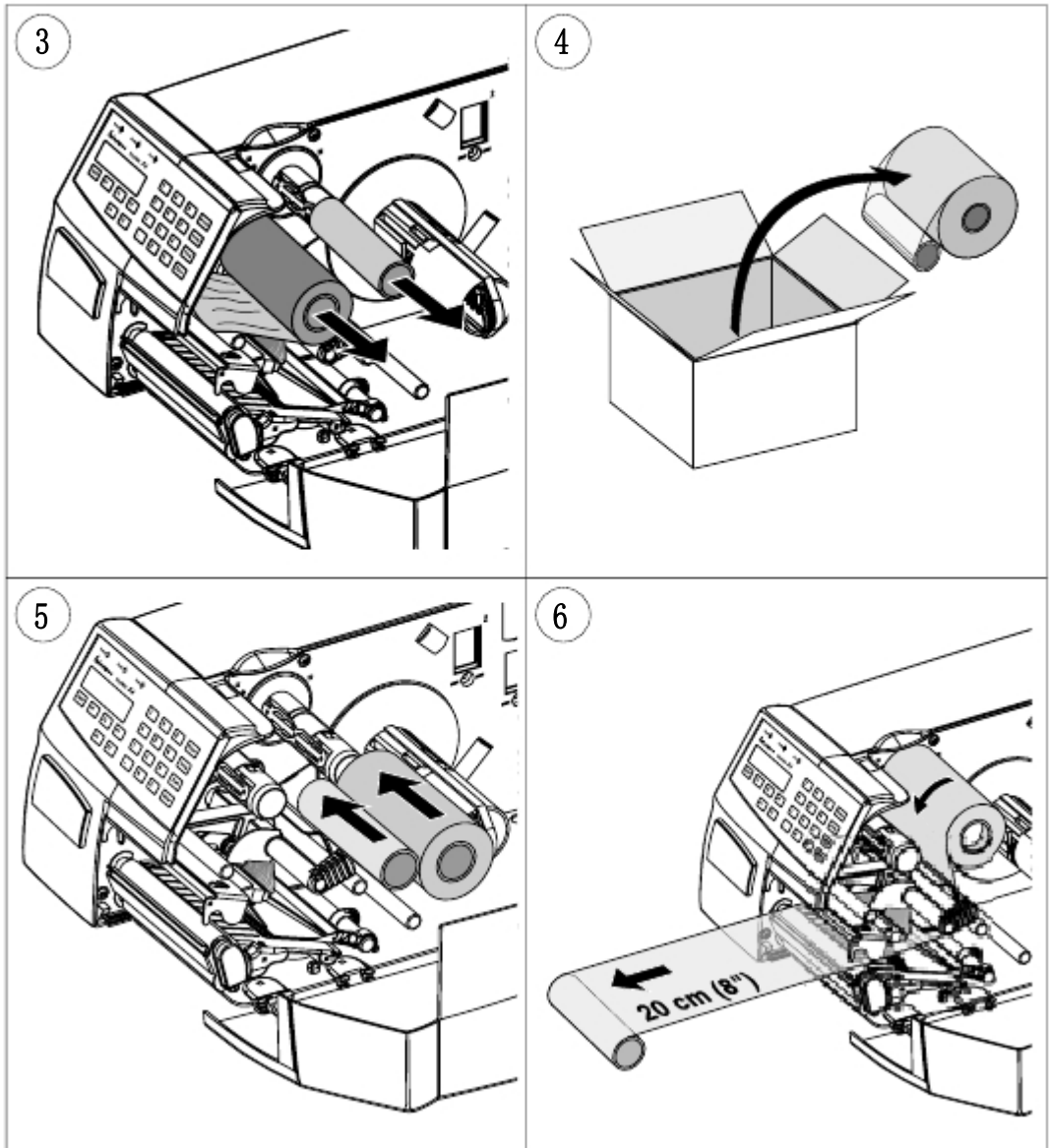
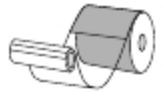

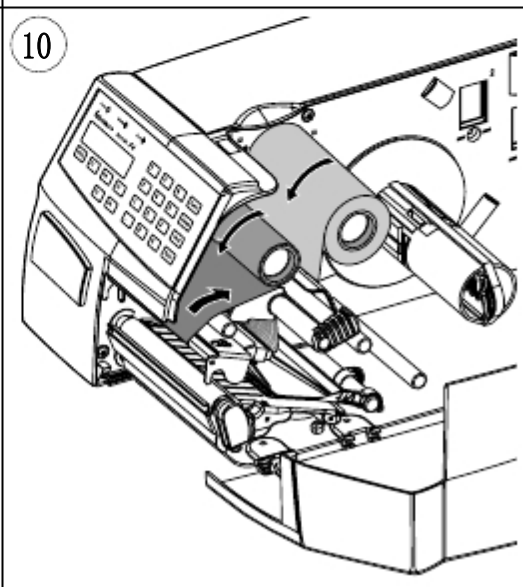
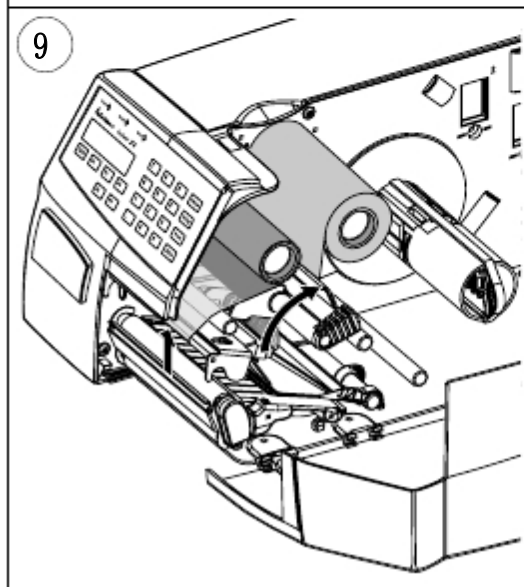
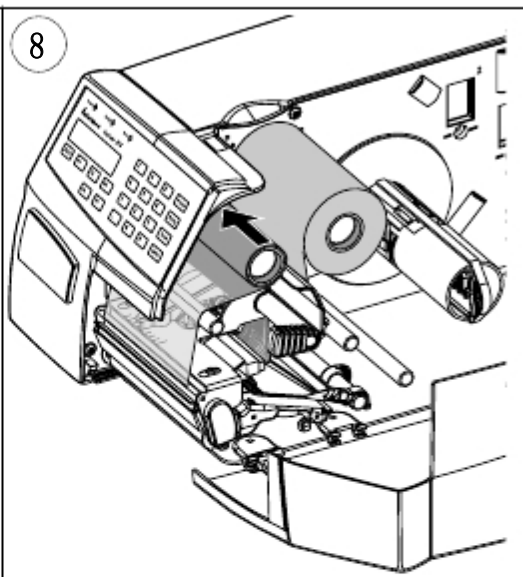
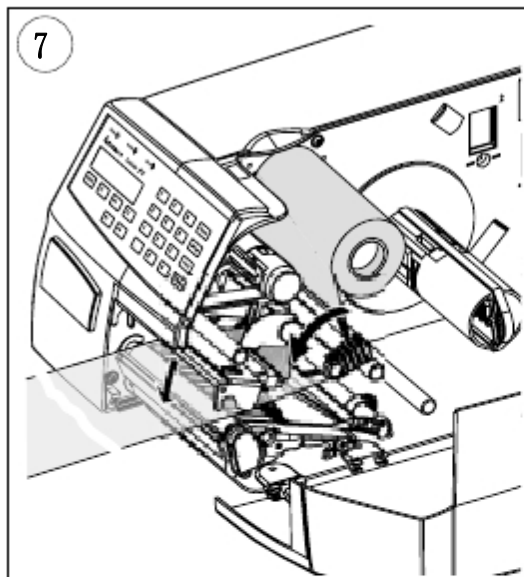
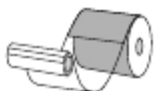

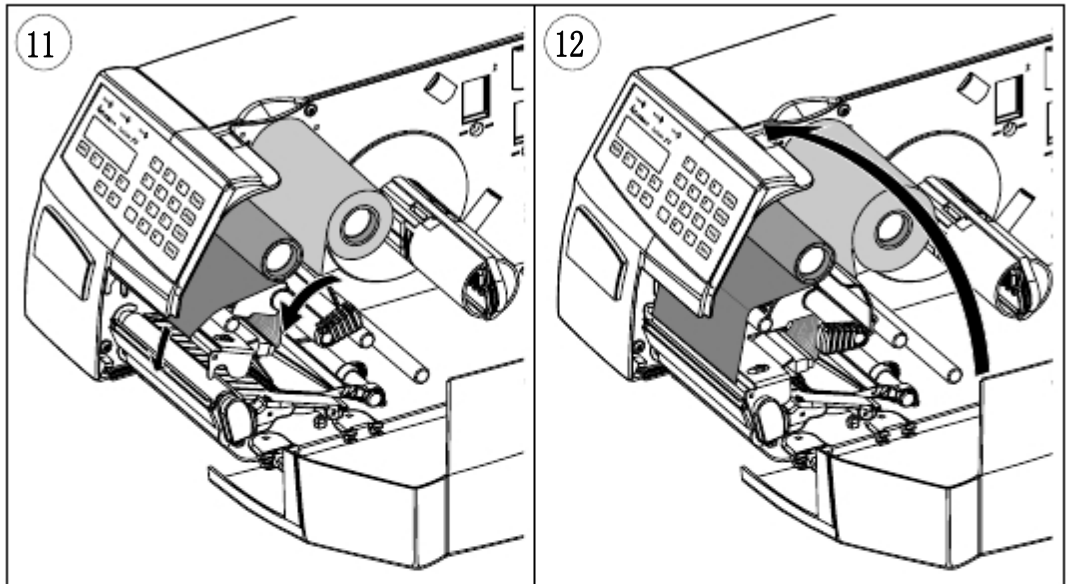
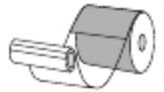

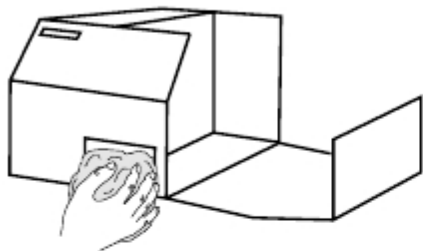

<i>Dansk</i>	Rengøring - Termohoved
<i>Deutsch</i>	Reinigung - Druckkopf
<i>Ελληνικά</i>	Καθαρισμός - Θερμικής κεφαλής
<i>English</i>	Cleaning - Printhead
<i>Español</i>	Limpieza - Cabeza de impresión
<i>Français</i>	Nettoyage - Tête d'impression
<i>Italiano</i>	Pulizia - Testa stampante
<i>Nederlands</i>	Reiniging - Printkop
<i>Norsk</i>	Rengjøring - Trykkhode
<i>Português</i>	Limpeza - Cabeça impressora
<i>Suomeksi</i>	Puhdistaminen - Painopää
<i>Svenska</i>	Rengöring - Tryckhuvud

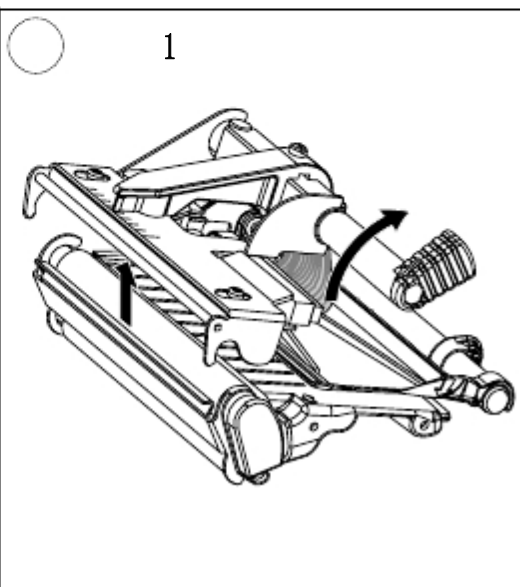
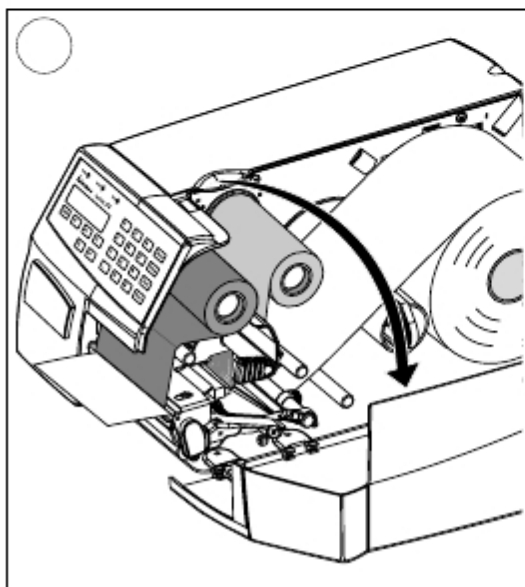

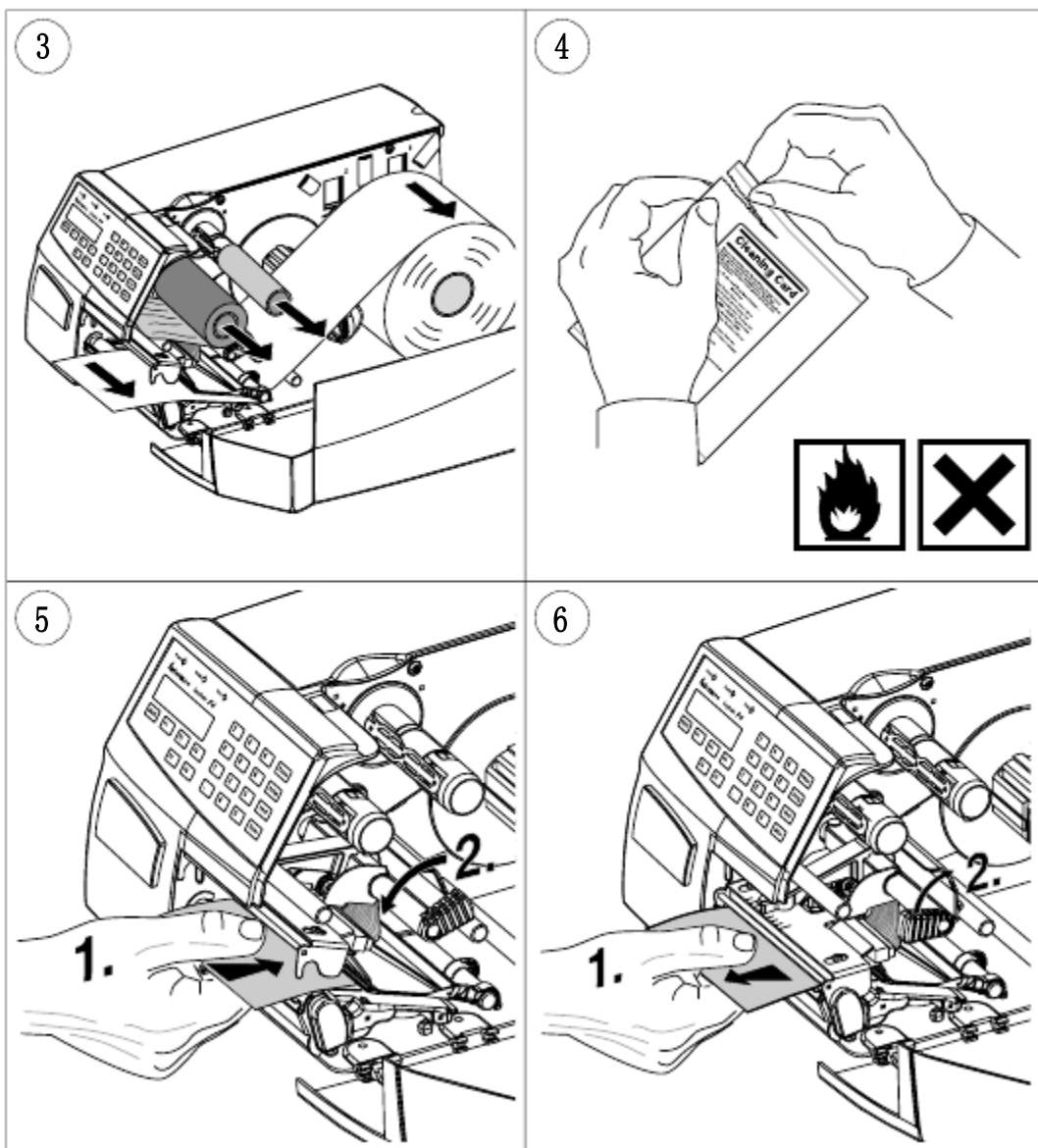

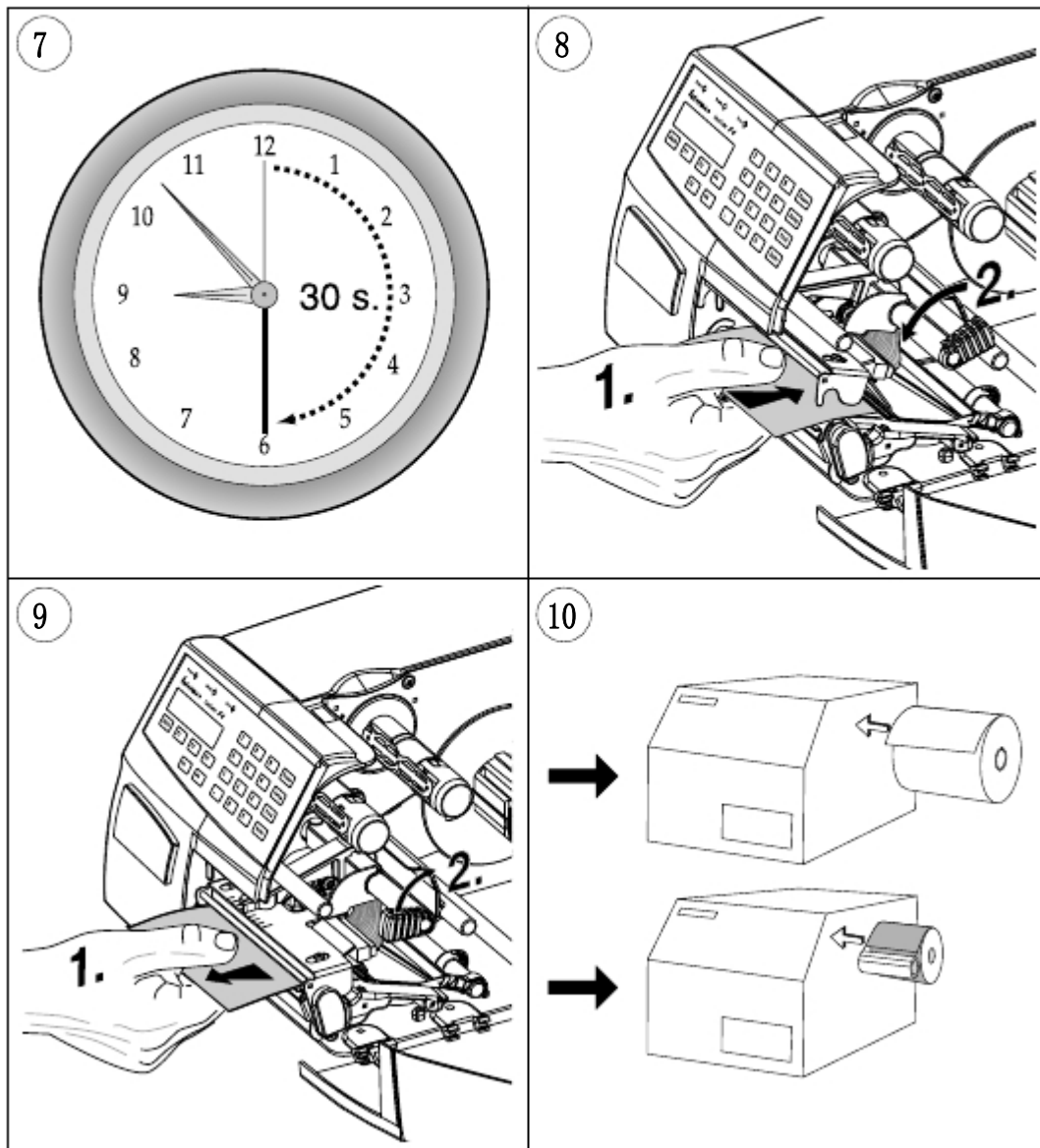

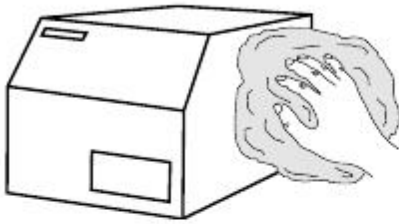
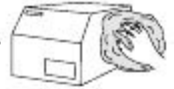

<i>Dansk</i>	Rengøring - Yderdæksel
<i>Deutsch</i>	Reinigung - Gehäuse
<i>Ελληνικά</i>	Καθαρισμός - Εξωτερικά
<i>English</i>	Cleaning - External
<i>Español</i>	Limpieza - Cubierta exterior
<i>Français</i>	Nettoyage - Extérieur
<i>Italiano</i>	Pulizia - Involucro esterno
<i>Nederlands</i>	Reiniging - Buitenkant omhulsel
<i>Norsk</i>	Rengjøring - Ytterdeksel
<i>Português</i>	Limpeza - Revestimento exterior
<i>Suomeksi</i>	Puhdistaminen - Ulkokuori
<i>Svenska</i>	Rengöring - Ytterhölje

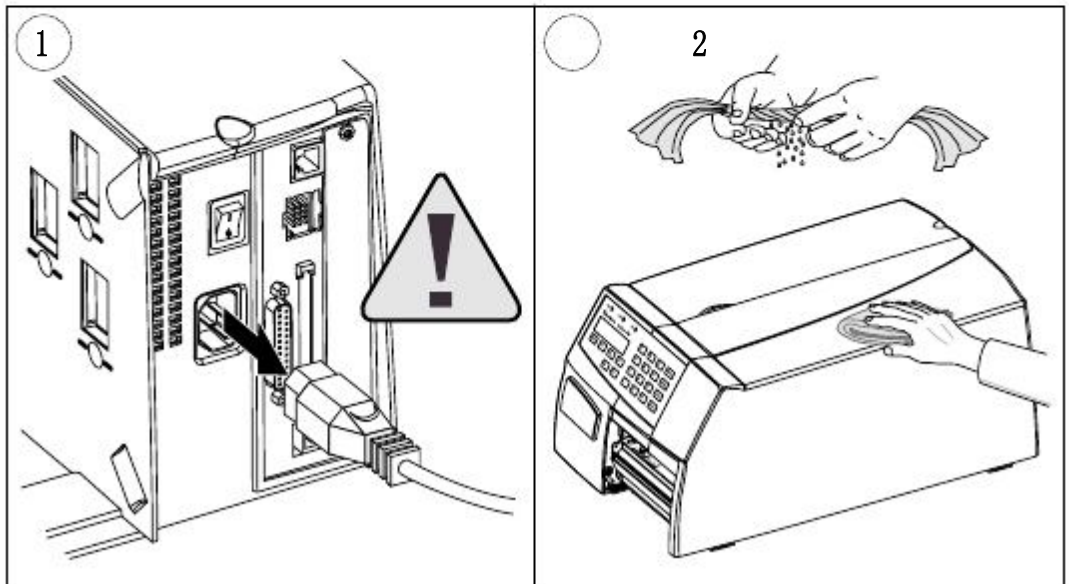

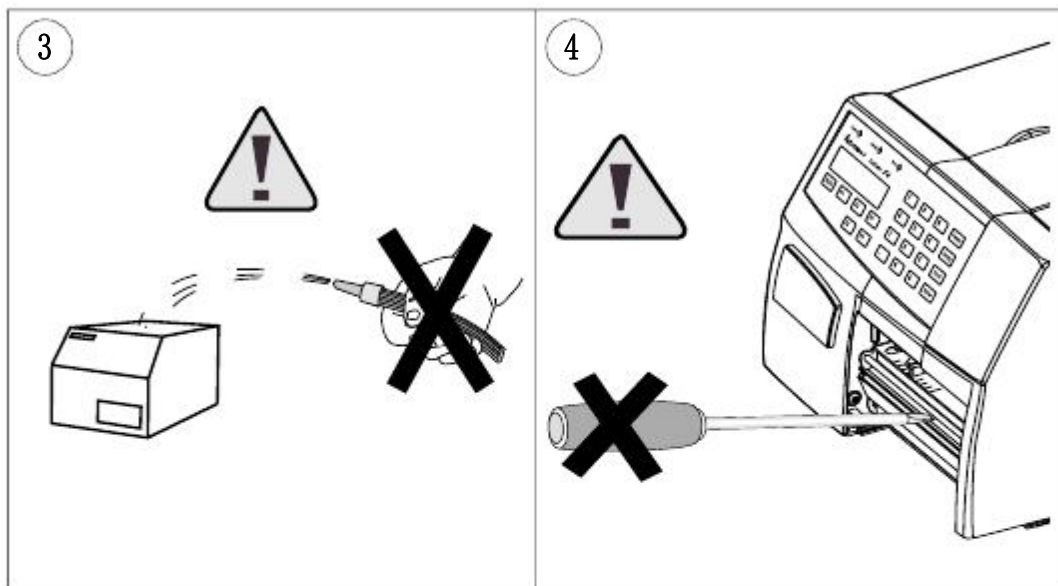

Information in this manual is subject to change without prior notice and does not represent a commitment on the part of Intermec Printer AB.

© Copyright Intermec Printer AB, 2001. All rights reserved. Published in Sweden.